

Pens Tutucu / ER Tip / DIN 6499 / DIN 69893 (HSK)

Toolholder - Collet Chuck / Type ER / DIN 6499 / DIN 69893 (HSK)

Spannzanghalter / Type ER / DIN 6499 / DIN 69893 (HSK)

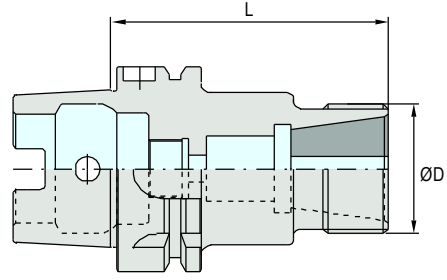

Kod Code Bezeichnung	Ölçüler Dimensions Abmessungen					
	Tip Type Type	Somun Collet Nut Spannmutter	Sıkma Aralığı Clamping Range Spannbereich	L	ØD	
HSK 50	ER16 105	ER16	TM 16 FM	1.0 - 10.0	105	28
	ER16 150	ER16	TM 16 FM	1.0 - 10.0	150	28
	ER20 75	ER20	TM 20 FM	1.0 - 13.0	75	34
	ER20 150	ER20	TM 20 FM	1.0 - 13.0	150	34
	ER25 75	ER25	TM 25 FM	2.0 - 16.0	75	42
	ER25 105	ER25	TM 25 FM	2.0 - 16.0	105	42
HSK 63	ER16 105	ER16	TM 16 FM	1.0 - 10.0	105	28
	ER16 150	ER16	TM 16 FM	1.0 - 10.0	150	28
	ER20 75	ER20	TM 20 FM	1.0 - 13.0	75	34
	ER20 150	ER20	TM 20 FM	1.0 - 13.0	150	34
	ER25 75	ER25	TM 25 FM	2.0 - 16.0	75	42
	ER25 105	ER25	TM 25 FM	2.0 - 16.0	105	42
	ER25 150	ER25	TM 25 FM	2.0 - 16.0	150	42
	ER32 105	ER32	TM 32 FM	3.0 - 20.0	105	50

Pens Tutucu / ER Tip / DIN 6499 / DIN 69893 (HSK)

Toolholder - Collet Chuck / Type ER / DIN 6499 / DIN 69893 (HSK)

Spannzanghalter / Type ER / DIN 6499 / DIN 69893 (HSK)

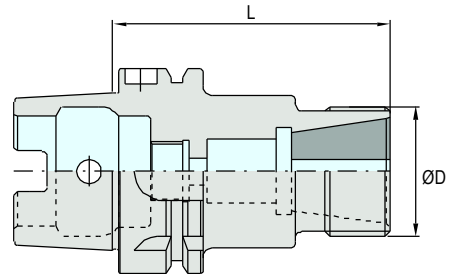

Kod Code Bezeichnung	Ölçüler Dimensions Abmessungen					
	Tip Type Type	Somun Collet Nut Spannmutter	Sıkma Aralığı Clamping Range Spannbereich	L	ØD	
HSK 80	ER16 105	ER16	TM 16 FM	1.0 - 10.0	105	28
	ER16 150	ER16	TM 16 FM	1.0 - 10.0	150	28
	ER20 75	ER20	TM 20 FM	1.0 - 13.0	75	34
	ER20 150	ER20	TM 20 FM	1.0 - 13.0	150	34
	ER25 75	ER25	TM 25 FM	2.0 - 16.0	75	42
	ER25 105	ER25	TM 25 FM	2.0 - 16.0	105	42
HSK 100	ER16 105	ER16	TM 16 FM	1.0 - 10.0	105	28
	ER16 150	ER16	TM 16 FM	1.0 - 10.0	150	28
	ER20 75	ER20	TM 20 FM	1.0 - 13.0	75	34
	ER20 150	ER20	TM 20 FM	1.0 - 13.0	150	34
	ER25 75	ER25	TM 25 FM	2.0 - 16.0	75	42
	ER25 105	ER25	TM 25 FM	2.0 - 16.0	105	42
	ER25 150	ER25	TM 25 FM	2.0 - 16.0	150	42
	ER32 105	ER32	TM 32 FM	3.0 - 20.0	105	50

Sipariş Örneği / Ordering Example / Bestellbeispiel ab Lager : HSK 50 ER16 105